



## Side Table

A Perfect Place to Hold the Artistic Book Shelf or Hutch

The Caretta Side Table features a solid cherry wood top, with soft, durable inlay, attractive wood accented legs, and functional lower shelf. This table is a great place to sit a lamp, artwork, or other items to display in your home or office. The table is also the perfect size to hold the Caretta Artistic Book Shelf, or Artistic or Modern Hutch.

The thick solid cherry table top features beautiful wood grain, a bull-nose edge and wood finish that are the same used in other Caretta Workspace products. This makes the Side Table fit perfectly into any Caretta office.

### Versions:

#### Side Table:

**Part #:** 531-0003-00-00-0

**Size:** H: 28.75" W: 53" D: 22"

**Weight:** 63 lbs.

- Solid Cherry Wood Top
- Soft, Durable Inlay
- Lower Shelf
- Wood Accent Legs



The thick, solid cherry top shows off the unique wood grain patterns. Each Side Table is one of a kind.

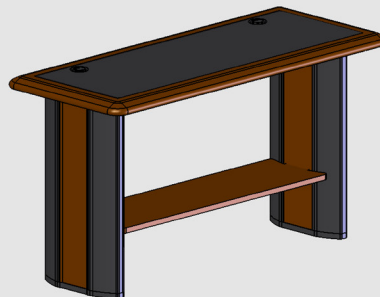
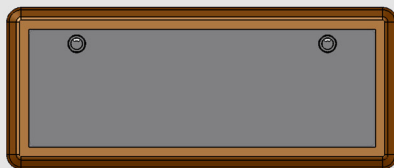

635 Enterprise Drive  
Lewis Center, OH 43035  
Phone: 614-430-8660  
[www.CarettasWorkspace.com](http://www.CarettasWorkspace.com)  
 Made in America

Questions? Call Us!  
(877) 422-1088

## Side Table: Features



### Attractive Look

The clean lines of the Side Table legs make this table an attractive piece in any office or home. The dramatic wood grain patterns in the thick solid cherry top with soft durable inlay make each table truly unique.

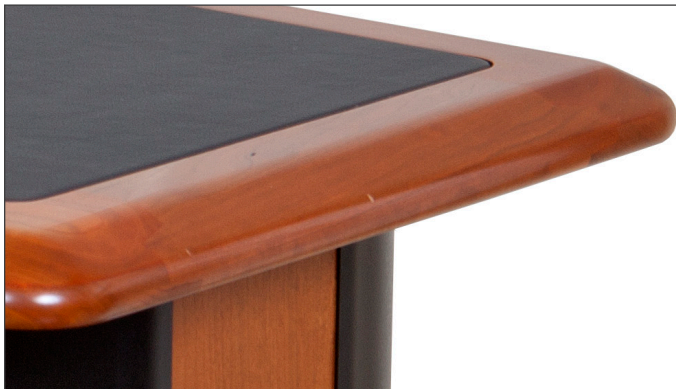

### Premium Solid Cherry Hardwood

The solid cherry hardwood used in the Side Table top is selected for its unique grain patterns, then finished with a durable, bright, natural cherry finish. Each piece goes through a detailed 10-step finish process, which is perfected with time and hand work.



### Lower Shelf

For an additional place to showcase artwork, framed pictures, speakers, or other items, the lower shelf is the ideal space. The organic shape of the shelf is elegant, yet functional.



### Leveling Feet

Each table leg has two large 3" round adjustable leveling foot pads. This adds stability to the table.



# Side Table: Photos

Tables

Tables

Side Table

Side Table



The **Side Table** is a great place to hold an Artistic Book Shelf from Caretta.



A **Side Table** with a Modern Hutch, 30" Lateral File Cabinet and Wave LED Lamp.



635 Enterprise Drive  
 Lewis Center, OH 43035  
 Phone: 614-430-8660  
 www.CarettaWorkspace.com  
 Made in America

Questions? Call Us!  
 (877)422-1088



# Side Table: Photos (continued)

Tables

Tables



A Side Table in an office with an Artistic Computer Desk 2, L Shaped Right, Artistic Book Shelf and Coat Tree.

Side Table

Side Table



A Side Table with an Artistic Hutch.



635 Enterprise Drive  
 Lewis Center, OH 43035  
 Phone: 614-430-8660  
[www.CarettaWorkspace.com](http://www.CarettaWorkspace.com)  
 Made in America

Questions? Call Us!  
 (877)422-1088

# Side Table: Dimensions

Side Table:

Part #: 531-0003-00-00-0

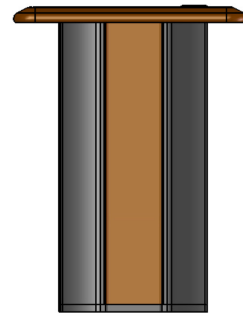
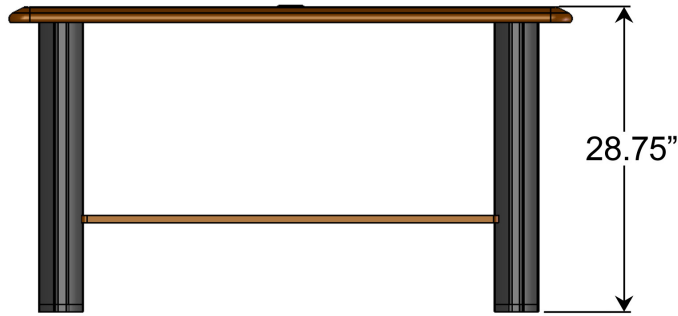
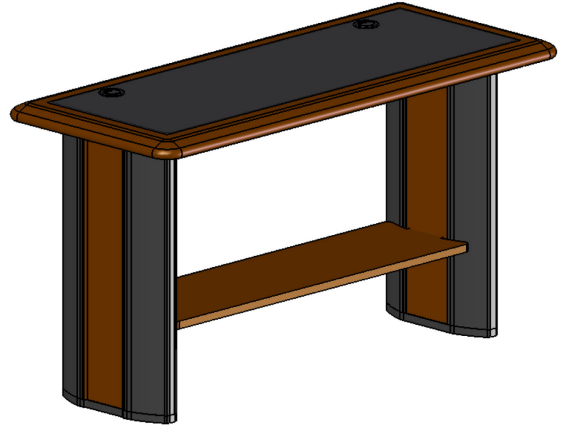
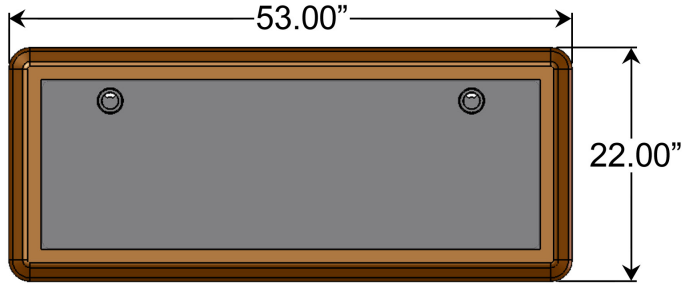

Tables

Tables

Side Table

Side Table



635 Enterprise Drive  
Lewis Center, OH 43035  
Phone: 614-430-8660  
[www.CarettaWorkspace.com](http://www.CarettaWorkspace.com)  
Made in America

Questions? Call Us!  
(877)422-1088



## Side Table: **Specifications**

Part Number:	<ul style="list-style-type: none"> <li>• Side Table: 531-0003-00-00-0</li> </ul>
Dimensions:	<ul style="list-style-type: none"> <li>• Side Table: H: 28.75" W: 53.00" D: 22.00"</li> </ul>
Weight:	<ul style="list-style-type: none"> <li>• Side Table: 63 lbs.</li> </ul>
Table Top:	<ul style="list-style-type: none"> <li>• Premium solid cherry hardwood frame</li> <li>• Hand selected for unique grain patterns</li> <li>• Wood source is FSC Certified</li> <li>• CNC manufacturing ensures precision fit joinery</li> <li>• Two, 2" wire grommets located on table top</li> </ul>
Rave® Inlay Material:	<ul style="list-style-type: none"> <li>• Material is of a quality indistinguishable from leather</li> <li>• Superior abrasion resistance (100,000 double rubs - Wyzenbeek/CFFA-1, Federal Standard 191A - Method 5304, wire screen)</li> <li>• Mildew resistant, UV stabilized pigments, light fastness/1,000 hours, antimicrobial, antibacterial</li> <li>• Meets: Motor Vehicle Safety Standard 302, California Tech Bulletin 117 section E, IMO A.652(16) 8.2 &amp; 8.3, UFAC class 1, BIFMA class A, NFPA 260 class 1, may comply with Cal 133 when tested with suitable components</li> </ul>
Wood Finish:	<ul style="list-style-type: none"> <li>• Natural cherry finish highlights wood grain</li> <li>• Hand-rubbed, 10-step finish process ensures quality</li> <li>• Meets or exceeds Standards of National Kitchen Cabinet Mfg. Association</li> <li>• Low VOC, formaldehyde free</li> <li>• Hand work in finish process ensures high quality</li> </ul>
Table Legs:	<ul style="list-style-type: none"> <li>• Aluminum structure painted black</li> <li>• Cherry center section</li> <li>• Legs each have two 3" round, adjustable levelers</li> </ul>
Lower Shelf:	<ul style="list-style-type: none"> <li>• Premium cherry hardwood board spans legs to provide extra storage</li> </ul>
Assembly:	<ul style="list-style-type: none"> <li>• One size of standard (1/4-20) screw threads into steel inserts</li> </ul>
Typical Lead Time:	<ul style="list-style-type: none"> <li>• In stock - 3 weeks</li> </ul>



635 Enterprise Drive  
 Lewis Center, OH 43035  
 Phone: 614-430-8660  
[www.CarettaWorkspace.com](http://www.CarettaWorkspace.com)  
 Made in America

Questions? Call Us!  
 (877)422-1088